

# AirSaver®

## F2 Cushioning System

### SETUP & INSTALLATION MANUAL

---



# AIRSAVER SETUP & INSTALLATION MANUAL

## TABLE OF CONTENTS

Introduction & Safety .....1

Diagram.....2

F2 Machine Setup.....3

Getting Started.....5

Optional Accessories.....6

Safety Precautions.....9

Troubleshooting.....9

## AIRSAVER F2 AIR CUSHIONING SYSTEM INTRODUCTION

The AirSaver F2 Air Cushioning System creates on-demand void-fill Air Pillows to streamline your shipping operations and reduce costs. The AirSaver system offers many advantages over traditional packaging materials like peanuts, paper or foam. The Air Pillow materials are stored flat on a roll until they are inflated and ready to use, which significantly reduces storage and shipping costs. In addition, Air Pillows are cleaner and easier to use compared to traditional materials and are the preferred packaging material of choice by today’s consumers. The AirSaver film material is recyclable and can be reused, which makes Air Pillows the most environmentally friendly packaging material in the market.

## SAFETY INSTRUCTIONS

- Make sure the power is disconnected before touching any electrical part of the machine.
- In case of an emergency, press the red emergency button on top of the machine. After the emergency has cleared, start the machine as described in the “Getting Started” section.
- During installation and setup, the machine should be off and power should be disconnected.
- Before replacing any parts, the machine should be turned off, disconnected and completely cooled down.

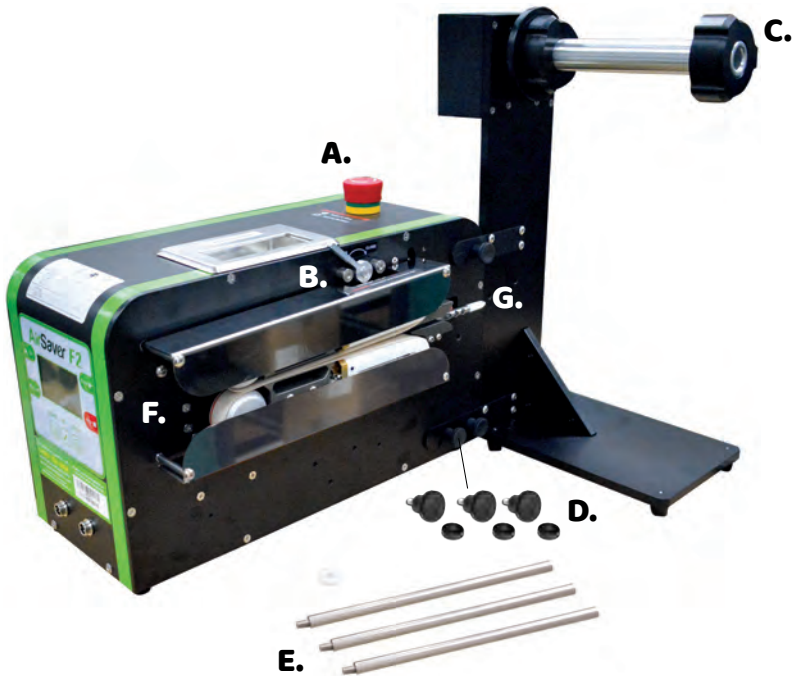
**F2 MACHINE DIAGRAM:****Figures:**

- A. Emergency Stop Button
- B. Lever
- C. Air Pillow Film Stand with Bracket
- D. Hand Screws and Washers
- E. Metal Feeding Rods
- F. Sealing Mechanism
- G. Feeding Tube

**Machine:**

Place the AirSaver F2 on a flat surface or on the AirSaver Mobile Cart to begin set up process.

# F2 MACHINE SETUP

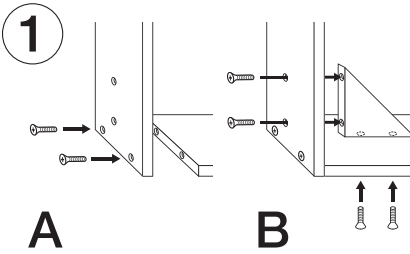

Please refer to above images A & B to assemble the Film Roller. Use the six screws & triangle brace provided.

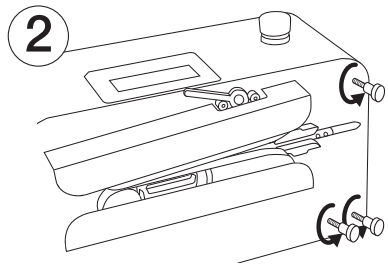

Loosen (but **DO NOT** remove completely) the back three hand screws on the F2 Machine.

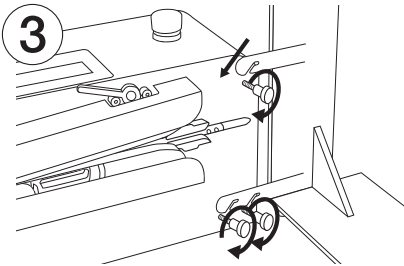

Connect the assembled Film Roller to the back three hand screws on the F2 Machine. Once in place, tighten the three screws.

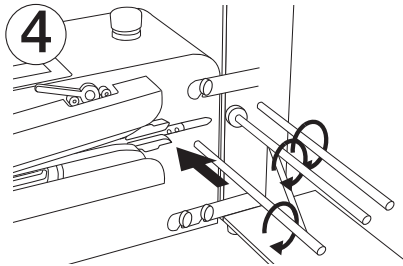

Screw in the three metal rods into the designated screw holes (one on the F2 machine, Two on the film Roller). Once the rods are in place take the white washer and place it through the middle rod.

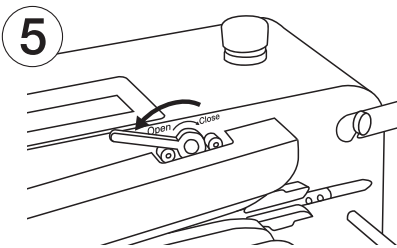

Flip the lever located on top of the F2 Machine to the **Open** position.

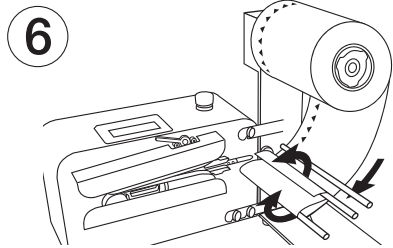

Load film onto the Film Roller ensuring that the text **Loads toward machine** is in that direction. After the film has been loaded, refer to the above image to properly feed the film through the three metal rods.

7

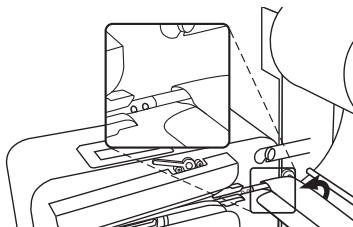

On the side of the film that is closest to the machine, create a small opening and thread it through the feeding tube. Pull the film to the front of the machine.

8

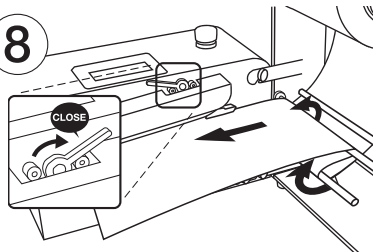

Flip the lever located on the top of the F2 Machine to the **Close** position.

9

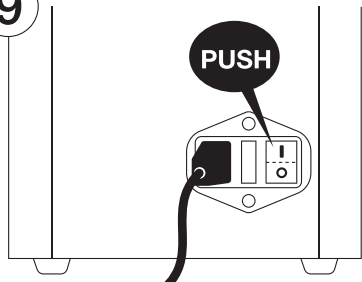

10

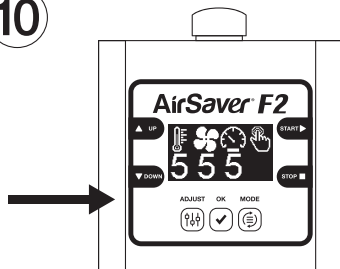

Key Description:

-  Start
-  Stop
-  Up
-  Down
-  MODE
-  OK
-  ADJUST

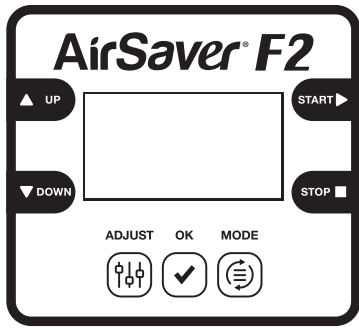

Screen Display:

-  Continuous Mode
-  Timing Mode
-  Basket Mode
-  Basket Full
-  Belt Speed
-  Temperature
-  Fan

Recommended Machine Settings			
Size	Temp	Fan	Speed
2" x 8"	7	7	8
4" x 8"	7	3	7
5" x 8"	7	3	7
8" x 8"	7	2-4	7
12" x 8"	7	2-3	4
12" x 16"	7	8	8

**WARNING:** If you adjust the fan speed too much, you may have Air Pillows that do not have sufficient air or Air Pillows that are too full which might not seal properly.

GETTING STARTED



1. Place the AirSaver Air Pillow Collection Basket or a large bin in front of the machine to use to collect/store the pillows.



2. Press the start button to begin generating pillows. Use the stop button to manually stop the process.



3. Each F2 Machine has a red emergency stop button at the top. When the button is pressed down, the machine will stop instantly and a red light will illuminate from the button. To release the emergency stop button, turn it clockwise. The machine will not run until the stop button is released.

## OPTIONAL ACCESSORIES

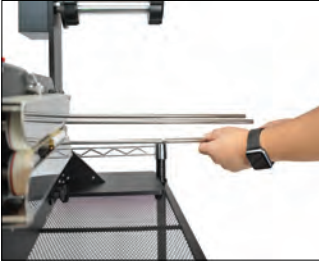

### Metal Extension Feeding Rods

Metal Extension Feeding Rods are needed when using 12" or larger rolls of film. Attach the extension rods by screwing them into the existing rods.



### AirSaver F2 Pillow Small Collection Basket

The AirSaver Pillow Small Collection Basket is designed to hold up to 10.4 cubic feet of Air Pillows. The casters make it easy to transport materials from one shipping station to another.

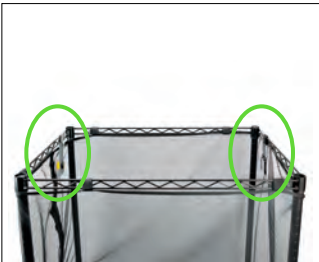

Sensor attached to the AirSaver Air Pillow Collection Basket.

Another option includes the sensor which can be attached directly to the unit. When running the machine with the sensor, it will automatically stop when the basket is full, never overflowing. Once the basket is low on Air Pillows, it will automatically start filling the collection basket with more pillows.

**WARNING:** By disabling the sensor, the F2 Machine will continue to generate air pillows until you manually stop the machine or until it runs out of film supply.



### **AirSaver Pillow Large Collection Basket**

The AirSaver Air Pillow Large Collection Basket is double the size of our Small Collection Basket holding up to 21 cubic feet of air pillows. This lightweight basket is on casters and is designed for mobility so that you can fill the basket with Air Pillows and move from one area to another. Reduce costs and streamline your shipping operations with this accessory. Ideal to use with timing mode.

**\*Not compatible with optional sensor.**



### **AirSaver F2 Mobile Cart**

The AirSaver Mobile Cart increases efficiency to shipping operations. The AirSaver F2 Machine can be placed on top of the mobile cart and is ready to use without needing to mount it. It has a full range mobility allowing you to move from one shipping station to another. You can store up to four boxes of AirSaver Film, saving you additional valuable space in the warehouse.



### **AirSaver F2 Foot Pedal**

The AirSaver Foot Pedal plugs directly into the AirSaver unit. With a simple step of the foot pedal the F2 machines becomes a hands free operation as result increasing packing speed and efficiency.



### **AirSaver Film Hopper**

The AirSaver Film Hopper can be placed to conveniently pull Air Pillows from overhead packing tables and packing lines. This will help prevent strain for larger fulfillment operations and enable packers to pack more products quickly.

## **AIRSAVER F2 CUSHIONING SYSTEM SAFETY PRECAUTIONS**

- Do not operate beyond its specified temperature, humidity or power source ratings. Do not use in an extreme environment where high temperature or high humidity exists. Use the F2 Cushioning System at temperatures within 0°C~40°C / 32°F~104°F (Storage). Altitude up to 6,561 feet.
- Input Rating: 100-240VAC, 50/60Hz, 5A
- This appliance is supplied with a molded three pin mains inlet for your safety and convenience. A 13 amp fuse is fitted in this inlet.

<b>TROUBLESHOOTING</b>	
Problem:	Solution:
Machine will not run when I press start	Check if the red emergency light is on and the button is pressed down. If it is, twist the button counter clockwise to release the button.
Film bags are not sealing properly	<p>A. Check temperature settings to verify it is the right setting for type of film used.</p> <p>B. Teflon belt may need to be replaced.</p> <p>C. Remove cover and make sure sealing mechanism is free of debris and/or loose plastic.</p> <p>If issue persist Contact AirSaver Technical Assistance 1-800-782-9008</p>
Bags caught in the sealing mechanism	<p>A. Pull out the film that is caught in the sealing mechanism and remove the pillows that are stuck. Make sure to clean any debris that may be stuck in the sealing mechanism and you are ready to re-insert the film and press start.</p> <p>B. Blade needs to be changed.</p> <p>If issue persists Contact AirSaver Technical Assistance 1-800-782-9008</p>
Machine constantly starts and stops	<p>Check the film and make sure that it is not blocking the sensor.</p> <p>If issue persists Contact AirSaver Technical Assistance 1-800-782-9008</p>
Error 1 Message	<p>Heating Unit Controller Failure</p> <p>Action: Reboot AirSaver F2.</p> <p>If issue persists Contact AirSaver Technical Assistance 1-800-782-9008</p>
Error 2 Message	<p>Fan Controller Failure</p> <p>Action: Please reboot AirSaver F2 If issue persists Contact AirSaver Technical Assistance 1-800-782-9008</p>
Error 3 Message	<p>Motor Controller Failure</p> <p>Action: Reboot AirSaver F2 If issue persists Contact AirSaver Technical Assistance 1-800-782-9008</p>
Error 4 Message	<p>Out of Film or Film Sensor Failure</p> <p>Action: Film is empty, Check if film is loaded correctly, If issue persists Contact AirSaver Technical Assistance 1-800-782-9008</p>
Error 5 Message	Non-AirSaver Film Installed

## NOTES

This image shows a single sheet of white paper with horizontal blue or grey ruling lines. The lines are evenly spaced and run across the width of the page. There are no margins, text, or other markings on the paper.

**AirSaver®**

Toll Free: 800-782-9008

Local: 951-738-4650

Fax: 951-273-2175

Email: [info@airsaverpack.com](mailto:info@airsaverpack.com)

Web: [www.airsaverpack.com](http://www.airsaverpack.com)